

## 2 Rear bumper

⇒ "2.1 Summary of components of rear bumper", page 83

⇒ "2.2 Summary of components - rear bumper - facelift", page 84

⇒ "2.3 Summary of components - rear bumper - (facelift - outdoor)", page 85

⇒ "2.4 Summary of components of rear bumper bracket", page 86

⇒ "2.5 Cutting out the openings for the parking aid sensors (drill)", page 86

⇒ "3 Cutting (drilling) openings for park steering assistant sender", page 88

### 2.1 Summary of components of rear bumper

#### 1 - Cap

#### 2 - Nuts

- 3, 5 Nm

#### 3 - Rear bumper - upper part

- Removing:



#### Note

*The top and bottom parts of the bumper can be removed simultaneously as one part "complete rear bumper" because these two parts are connected with plastic clips.*

- Remove tail lights → Electrical System ⇒ Rep. gr. 94 .
- Unclip cover strips -1-.
- Remove screws -6-.
- Remove the expanding rivets -4-.
- Unscrew nuts -2-.
- Push rear bumper to the rear.



#### Note

*Before removing the bumper it is necessary to disconnect plug of park sensors (if present).*

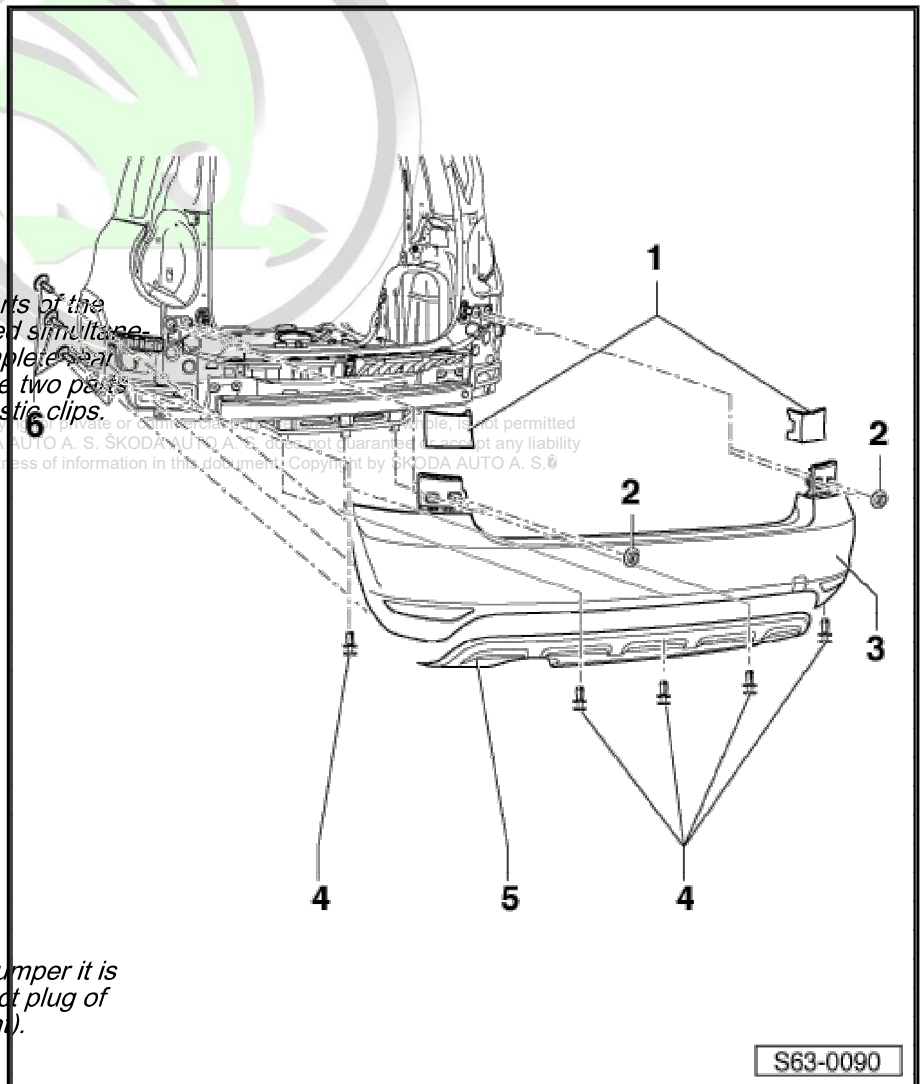

#### Install

- Installation is carried out in the reverse order.



#### 4 - Body-bound rivet

#### 5 - Rear bumper - lower part

#### Removing

See rear bumper- remove upper part ⇒ [page 83](#) .

- Unclip from rear bumper - top part -3-.

#### Install

- Installation is carried out in the reverse order.

#### 6 - Screw

- 1 Nm

## 2.2 Summary of components - rear bumper - facelift

#### 1 - Adjusting nut

#### 2 - Guide section

#### 3 - Screw

- 1, 5 Nm

#### 4 - Nuts

- 3, 5 Nm

#### 5 - Right attachment strip

#### 6 - Nuts

- 3, 5 Nm

#### 7 - Rear bumper bracket

Removing and installing  
⇒ [page 86](#) .

#### 8 - Bore cover for towing eye.

#### 9 - Rear reflector

- Clipped into the bumper.

#### 10 - Cap

- Clipped into the bumper.

#### 11 - Expanding rivet

#### 12 - Rear spoiler

- Clipped into the bumper.

#### 13 - Nuts

- 3, 5 Nm

#### 14 - Expanding rivet

#### 15 - Rear bumper

Removing and installing: ⇒ [page 83](#) .

#### 16 - Screw

- 20 Nm

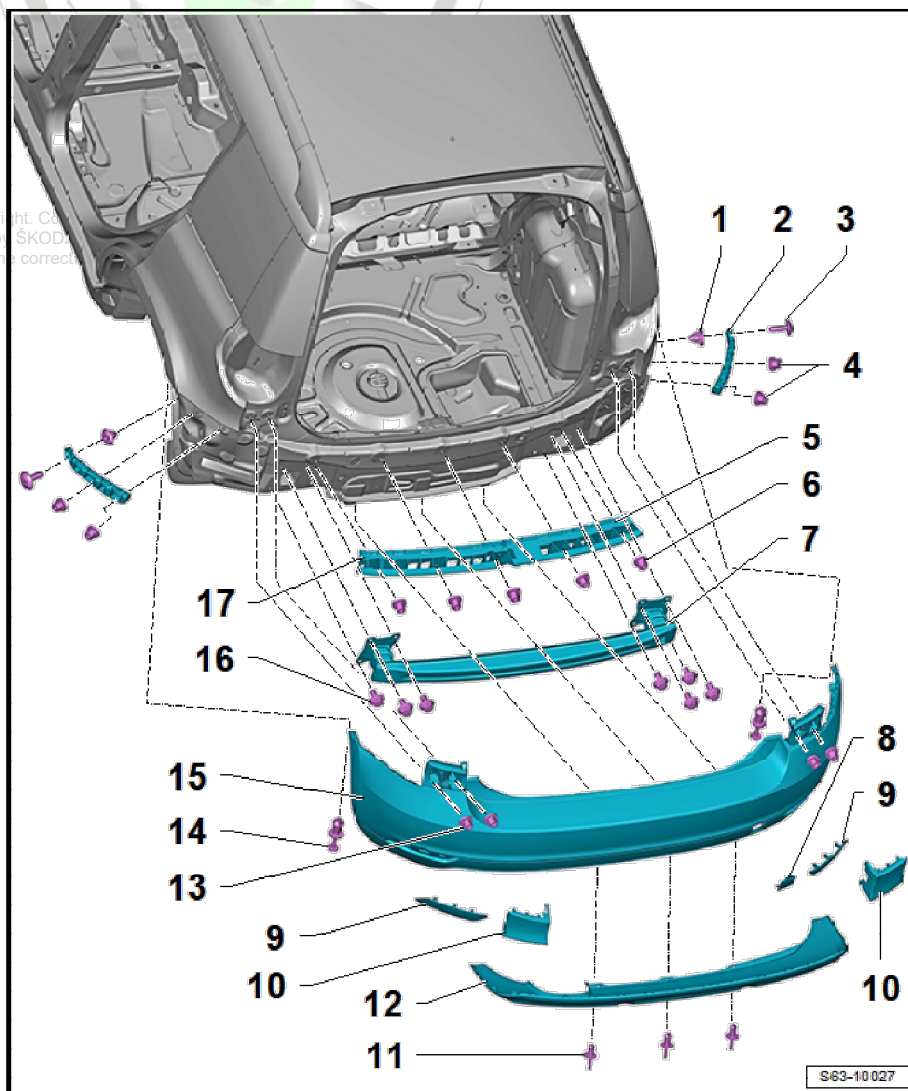

S63-10027

## 17 - Left attachment strip

### 2.3 Summary of components - rear bumper - (facelift - outdoor)

1 - Adjusting nut

2 - Guide section

3 - Screw

□ 1, 5 Nm

4 - Nuts

□ 3, 5 Nm

5 - Right attachment strip

6 - Nuts

□ 3, 5 Nm

7 - Rear bumper bracket

Removing and installing  
⇒ [page 86](#) .

8 - Cap

- Clipped into the bumper.

9 - Rear reflector

- Clipped into the bumper.

10 - Bore cover for towing eye.

11 - Expanding rivet

12 - Rear spoiler

- Clipped into the bumper.

13 - Lower bumper section

- Clipped into the bumper.

14 - Expanding rivet

15 - Rear bumper

Removing and installing: ⇒ [page 83](#) .

16 - Screw

□ 20 Nm

17 - Left attachment strip

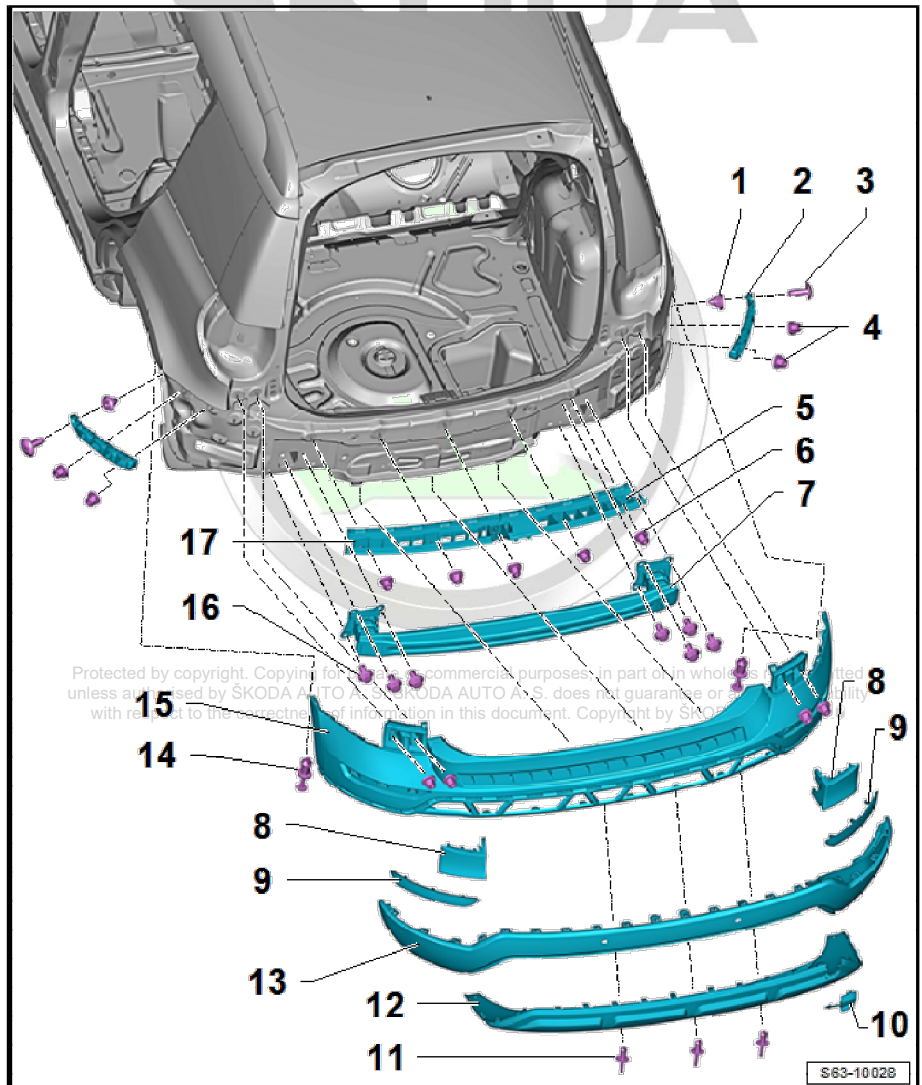



## 2.4 Summary of components of rear bumper bracket

- 1 - Adjusting nut
- 2 - Right guide part
- 3 - Nuts
  - 3.5 Nm
- 4 - Screw
  - 1.5 Nm
- 5 - Screw
  - 20 Nm
- 6 - Rear bumper bracket

### Removing

- Remove the rear bumper ⇒ [page 83](#) .
- Remove screws -5-.
- Remove rear bumper bracket.

### Install

- Installation is carried out in the reverse order.

- 7 - Right mounting bracket
- 8 - Nuts
  - 3.5 Nm
- 9 - Left mounting bracket
- 10 - Left guide part

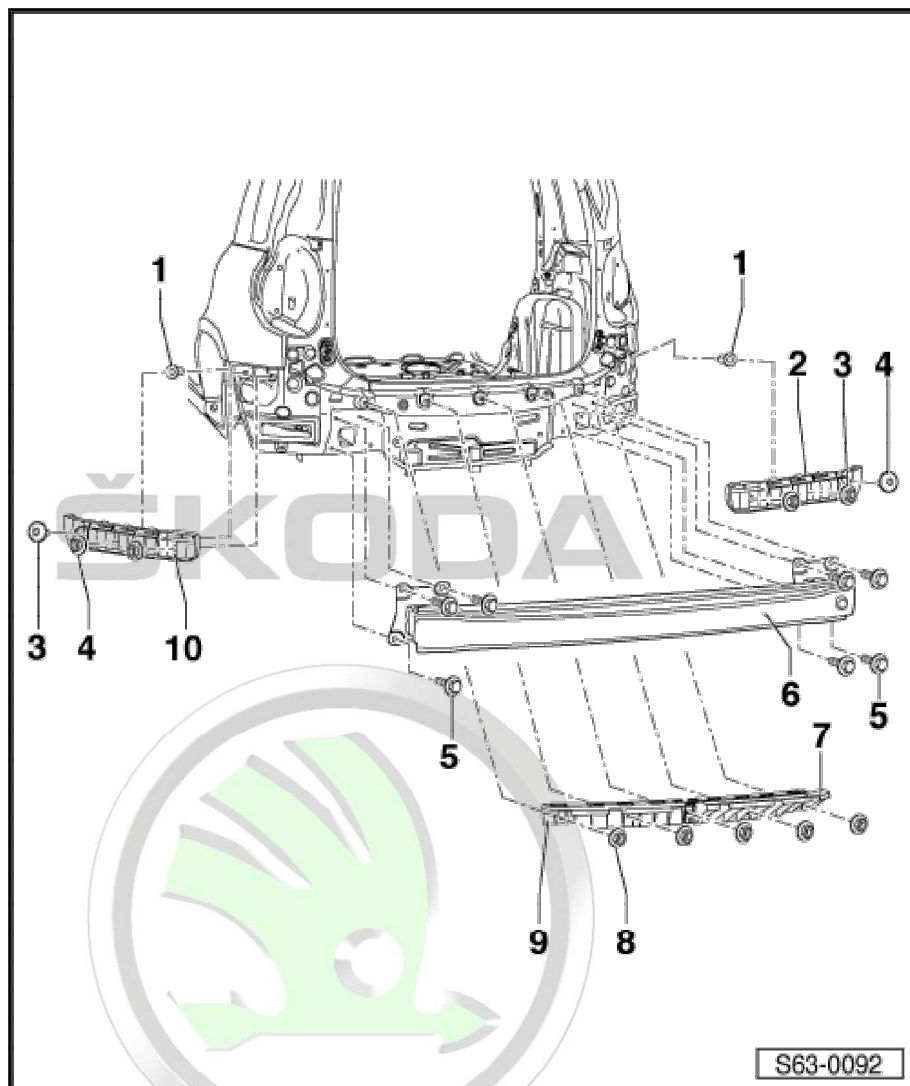

## 2.5 Cutting out the openings for the parking aid sensors (drill)

### Predrill the openings



#### Note

*Avoid damage to the painted bumper side!*

- Removing the bumper ⇒ [page 83](#) .
- In the area of the sketched out axle crosses, mark the centres for drilling four openings using a suitable tool.

- Drill an opening with a diameter of 8 mm.

#### Drilling out the openings for the sensors

- Use the cutting tool BEA 000 001 or a step drill in order to cut out the opening (diameter 18 mm).

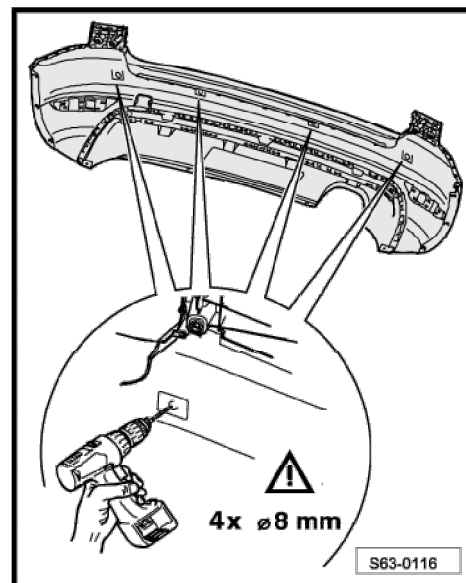

- First of all make the openings from the outer side of the bumper when using a step drill. Complete the work step from the inner side of the bumper.
- Trim the openings in a suitable manner in order to avoid damage to the paintwork.

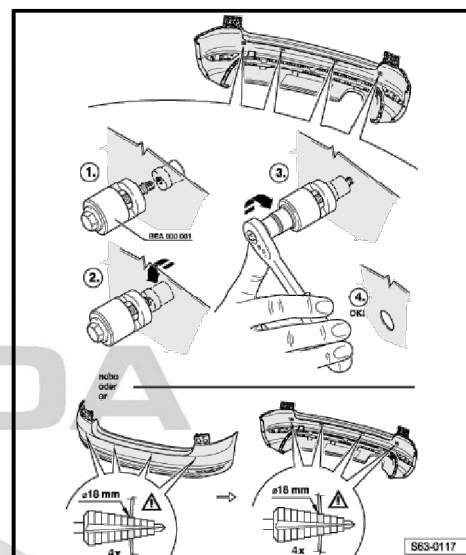





### 3 Cutting (drilling) openings for park steering assistant sender



#### Note

*Avoid damage to the painted bumper side!*

#### Cut out opening in the front bumper

- Remove wheelhouse liner ➔ [page 102](#) .
- The position of the opening for the park steering assistant sender is marked on the inside of the bumper - 1 - .
- Bore a hole with a Ø 6 mm drill.
- Use -Schraubenlocher - TME01- in order to cut out the opening.
- After cutting out the opening, inspect for burrs, if necessary clean the edges.
- Proceed in the same way on the opposite side of the bumper.
- The work sequence for the removal and installation of the sender is described in the workshop manual ➔ Electrical System; Rep. gr. 94 .
- Install the front wheelhouse liner after installing and connecting the park steering assistant sender ➔ [page 102](#) .

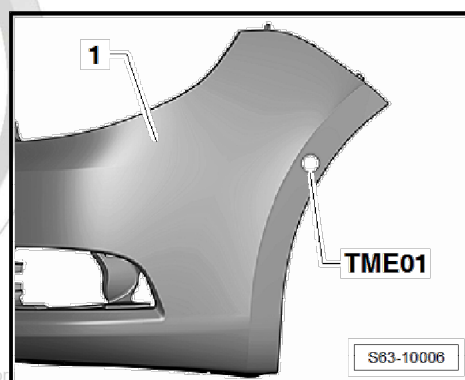

#### Cut out opening in the rear bumper

- Remove wheelhouse liner ➔ [page 102](#) .
- The position of the opening for the park steering assistant sender is marked on the inside of the bumper - 1 - .
- Bore a hole with a Ø 6 mm drill.
- To cut out the opening - 2 - use -Schraubenlocher - TME01- .
- After cutting out the opening, inspect for burrs, if necessary clean the edges.
- Proceed in the same way on the opposite side of the bumper.
- The work sequence for the removal and installation of the sender is described in the workshop manual ➔ Electrical System; Rep. gr. 94 .
- Install the front wheelhouse liner after installing and connecting the park steering assistant sender ➔ [page 102](#) .

