

2 Rear seats

⇒ [a2.1 nd installing the rear seat bench / individual seats", page 197](#)

⇒ [a2.2 nd installing backrests", page 200](#)

⇒ [a2.3 nd installing the lock for the rear seat backrest", page 201](#)

2.1 Removing and installing the rear seat bench / individual seats

Removing

- Remove the cover caps for the ISOFIX child seat mountings.

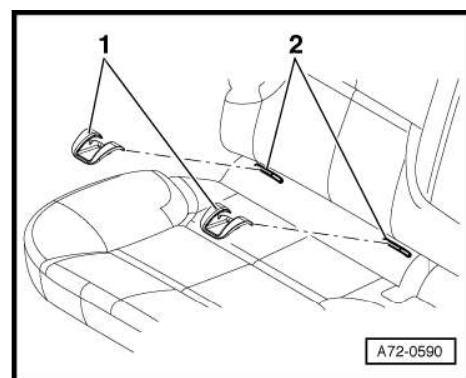

- First undo the top part - 1 -.

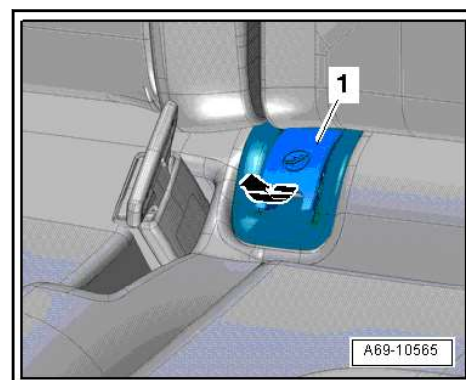

- Afterwards, release the bottom part - 1 - and remove from the lug - 2 -.

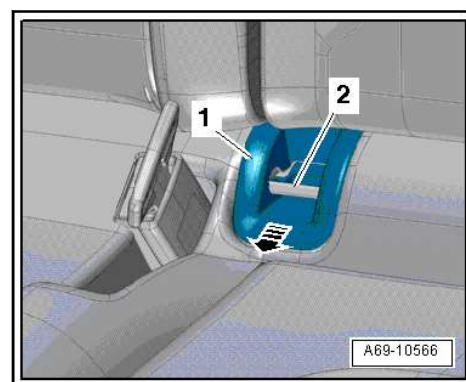

- Grip on both sides with both hands under the seat bench - 1 - in the area of the mounting grommet - 2 -



and pull up forcefully and with a sudden motion in the
-direction of arrow-.

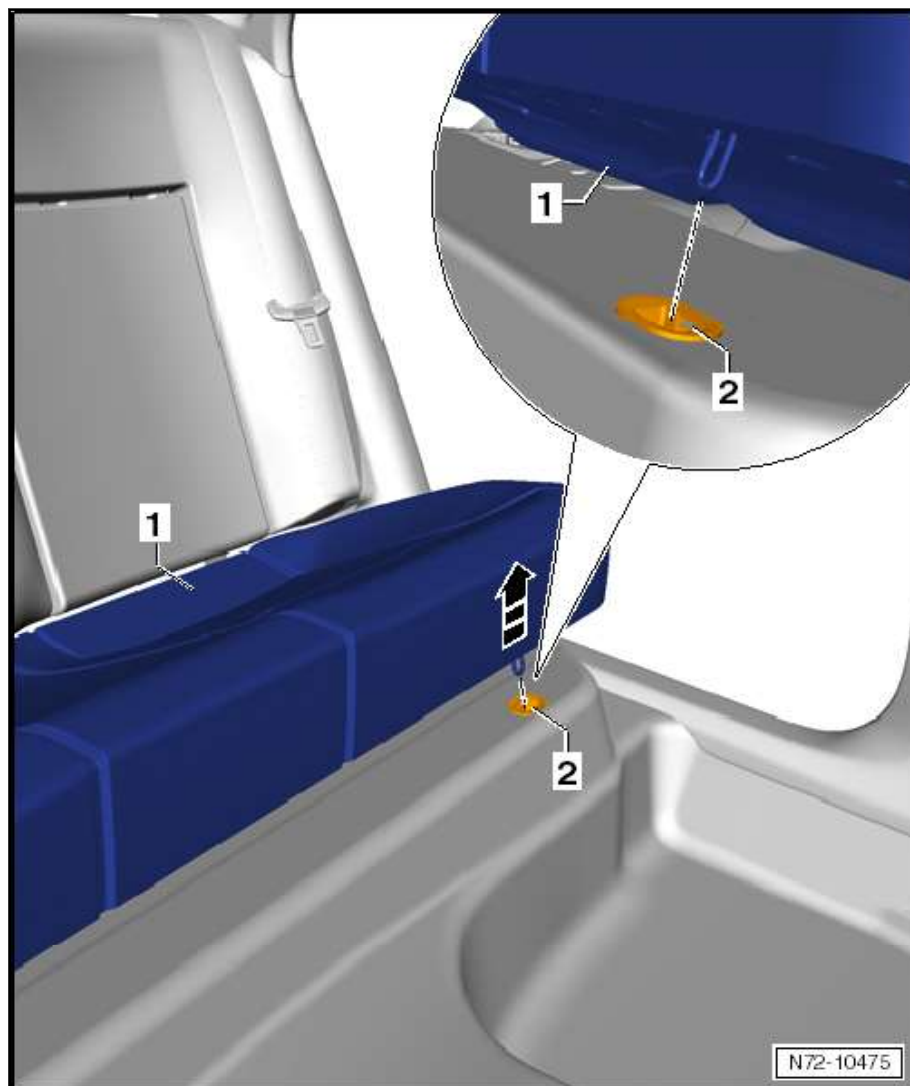

- Disconnect plug for seat heating (depending upon vehicle equipment).

Installing

- Connect the plug connections for seat bench heating (depending on vehicle equipment).
- Before assembling the seat bench - 2 - replace the mounting grommets as these parts are not designed for reuse.

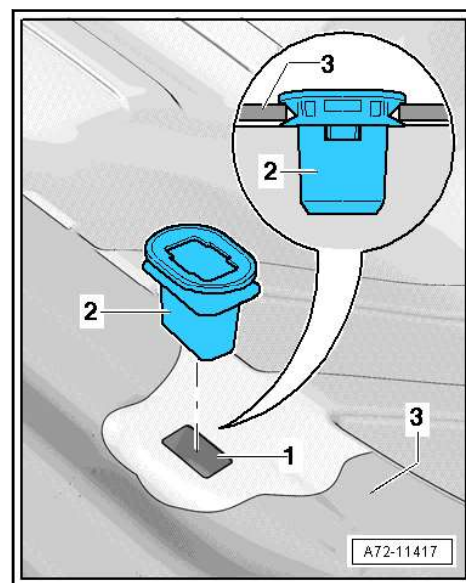

- Insert seat bench in - direction of arrow - on both sides with the crash hooks - 1 - into the mounting grommets - 2 - until they audibly click into place.

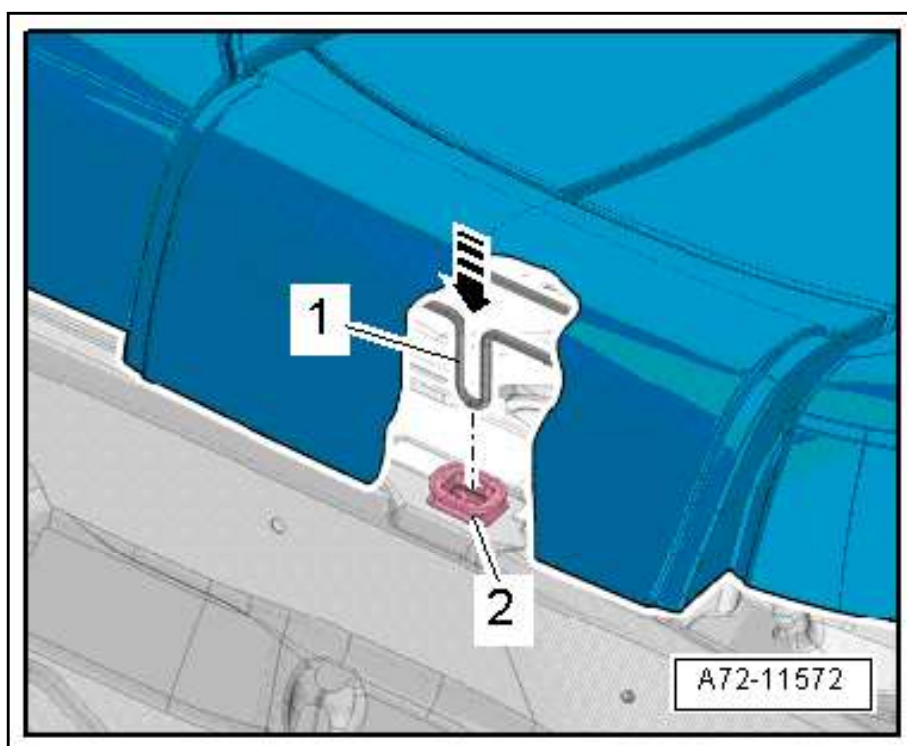

- Install the cover caps for the ISOFIX child seat mountings.



Check seat bench for firm seating after installing.